

SDR[®] Plus

Bulk Fill Flowable

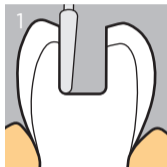

1
Cavity Preparation

Keep the cavity preparation to a minimum.



2
Matrix Placement

For Class II restorations place a matrix and wedge. Use of pre-contoured matrix bands is recommended.

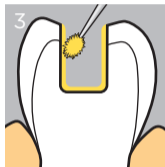

3
Adhesive Application

Refer to adhesive manufacturer's directions for properly applying adhesive. Light cure taking depth of cavity into account.

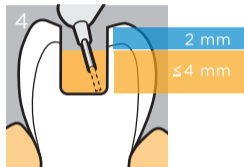

4
SDR[®] Plus Application

Begin at the deepest portion of the cavity. Gradually withdraw while filling.

SDR® Plus Bulk Fill Flowable



Caution, consult
instructions for use

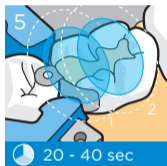

Light Curing

Light cure with a minimum output of 550 mW/cm².

U shade ≥ 20 sec.
A shades ≥ 40 sec.

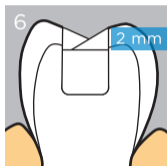

Placement of Universal Composite

Restore occlusal 2 mm with oblique layers to facilitate occlusal contouring. Light cure according to the manufacturer's instructions for use.

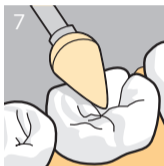

Finishing & Polishing

Contour the restoration using finishing burs or diamonds. Finish the restoration by applying medium pressure and slowly back off to a light

pressure. For a glass-like luster, polish the restoration.

Dentsply DeTrey GmbH
De-Trey-Str. 1
78467 Konstanz
GERMANY
www.dentsplysirona.com

© 2017 Dentsply Sirona, Inc.

 **Dentsply
Sirona**